

# 4 FT. ALUMINUM SLAT BENCH SPECIFICATIONS

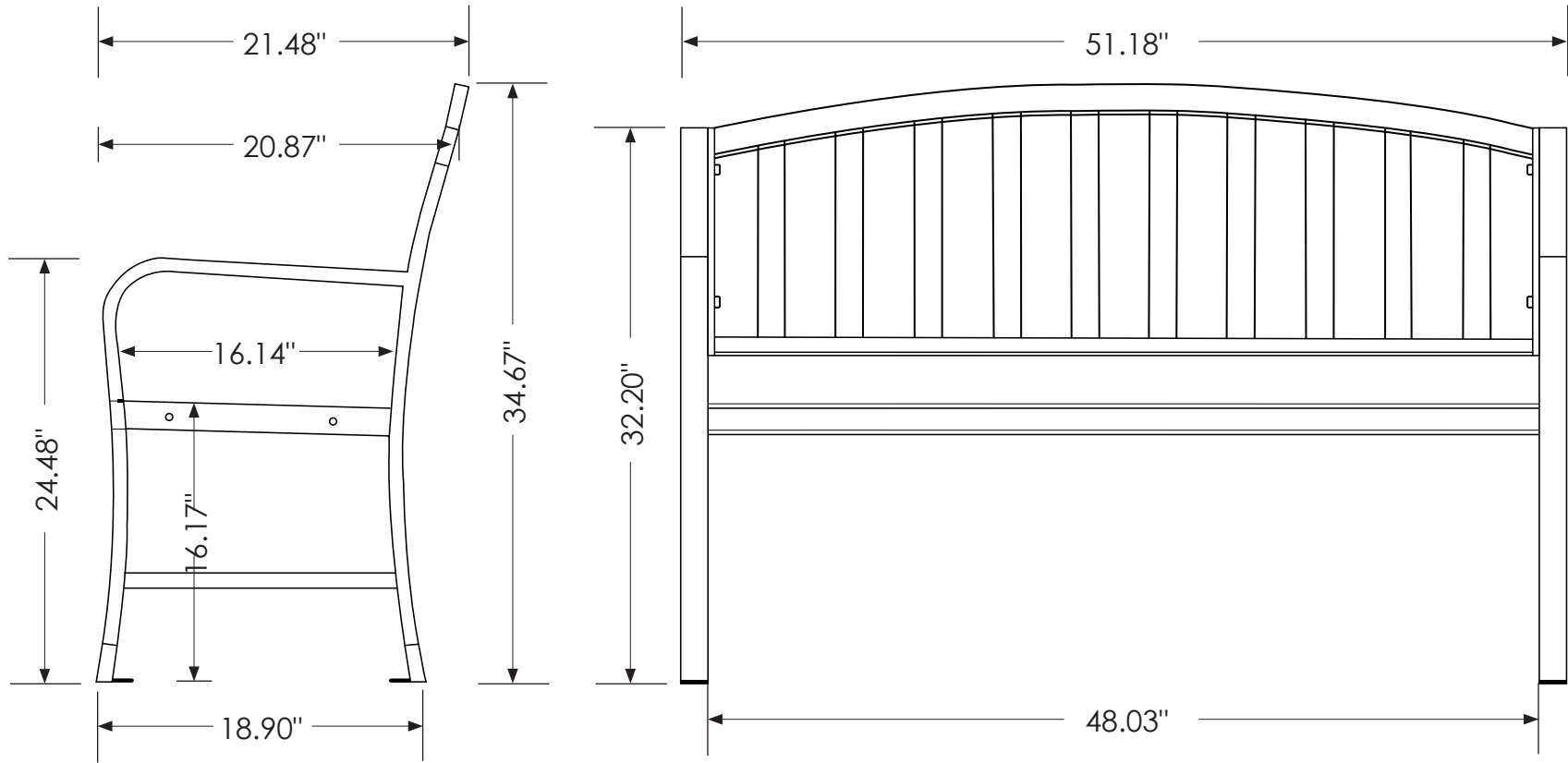

TOTAL WEIGHT: 31 lbs

**NOTES:**

- 1) Material: Extruded aluminum tubes
- 2) Coating: Powder-coated
- 3) Black zinc-plated assembly hardware included
- 4) Surface mount hardware not included
- 5) 7/16" surface mounting holes

